

# Product Termination Notification

## HPS Nuclear Droplight



**Description of Change:** DRPLT-1000/Q and DL-1000/Q bulbs now obsolete

**Classification of Change:** Product Termination

**Reason for Change:** All Suppliers of high pressure sodium bulbs have discontinued manufacturing

**Expected Influence on Quality/Reliability/Performance:** Not applicable

**Part Number/Series/Family Affected:**

Part Number(s):

80-02100-01

80-02100-02

80-02101-01

**Time Schedule:**

Last Time Buy Date: **Inventory has been depleted**

Last Time Shipment Date: **Inventory has been depleted**

**Recommended Replacement: HP-LED Droplight**

Part #80-90274-01 Wall Configuration

Part #80-90296-01 Radial Configuration

Part #80-90297-01 Axial Configuration

Datasheet enclosed. Pricing are available on request.

# **New HP-LED 3 in 1 Droplight**



## **3 Configurations for Better Inspection Illumination**

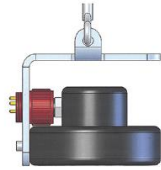

### **AXIAL CONFIGURATION**

Special Adapter plate projects light downwards, illuminating reactor cavity.



### **RADIAL CONFIGURATION**

Special adapter bracket configures light head to project the light along the lower core support plate and allows the HP-LED Droplight to fit and rest on top of the lower core support plate flow holes.



### **WALL MOUNT CONFIGURATION**

Designed to rest against cavity wall for general illumination of the core.

**For further information please contact Remote Ocean System Sales:**

**TEL: 858-256-2810 or 858-256-2808**

**Email: [jamesc@rosys.com](mailto:jamesc@rosys.com) or [ray@rosys.com](mailto:ray@rosys.com)**